

STEP 17 Coupler attachment for bikes with quick-release rear axles.
(Note: If your rear bike tire has two hub nuts please refer to Steps 15 & 16.)

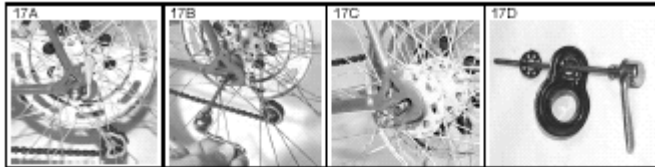

- 17A. Flip open the quick-release lever, and remove the nut and spring from the opposite side.
- 17B. Hold the lever and pull the axle skewer with spring out.
- 17C. Completely remove the skewer but leave the wheel in place.
- 17D. Slide the coupler plate and tab washer onto the skewer. **IMPORTANT!** The wide end of the spring should face out and touch the lever, the bell of the coupler plate should face out, and the tab washer hook should face in toward the wheel hub.

STEP 18 Attach trailer tow bar to bike

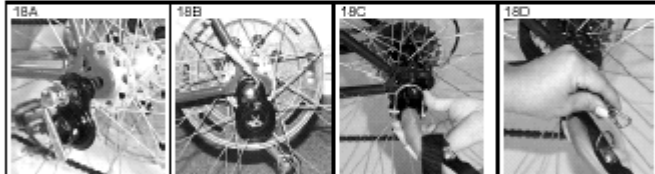

- 18A. Insert end of skewer through wheel hub and fit tab washer hook into slot in bike frame dropout.
- 18B. Replace the spring (wide end out) over the end of the skewer, followed by the nut. Tighten the nut by hand and clamp the lever down.
- 18C. Insert the end of the trailer tow bar into the large hole and fasten the Q/R pin.
- 18D. **IMPORTANT!** Loop the safety strap around the bike frame and clip the end into the "D" ring at the end of the tow bar.

⚠. WARNING Safety strap must attach to the bike frame when using this product in trailer mode.

Please proceed to **STEP 19** for instructions on the proper use of the safety harnesses.

STEP 15 Coupler attachment for bikes with rear hub nuts.
(Note: If your rear bike tire has a quick-release rear axle please proceed to Steps 17 & 18)

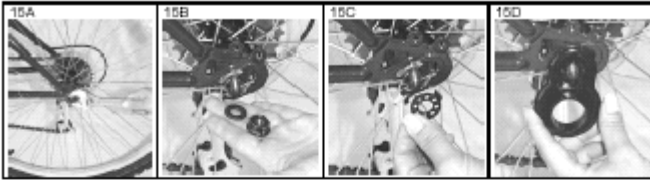

- 15A. Loosen the rear bike hub nut with a wrench.
- 15B. Remove the hub nut and washer from the bike.
- 15C. Slide the tab washer over the axle so the tab fits into the slot in the bike frame dropout.
- 15D. Position the coupler plate over the axle so that the pegs on the back of the plate fit into the holes in the tab washer, and the coupler plate is vertical with the large hole below the axle.

STEP 16 Attach trailer tow bar to bike

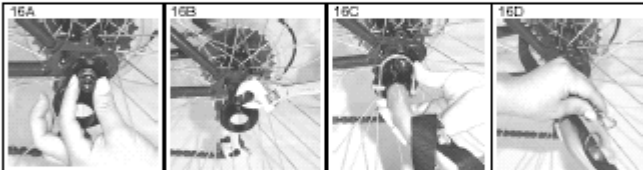

- 16A. Replace bike hub nut and washer and tighten by hand.
 - 16B. Tighten the bike hub nut securely with a wrench.
 - 16C. Insert the end of the trailer tow bar into the large hole and fasten the Q/R pin.
 - 16D. Loop safety strap around bike frame and clip the end into the "D" ring at the end of the tow bar.
- ⚠️ WARNING Safety strap must attach to the bike frame when using this product in trailer mode.**